



Rialtas na hÉireann
Government of Ireland



Arna chomhchistiú ag
an Aontas Eorpach

Co-funded by the
European Union



Tionól Reigiúnach
Oirthir agus Lár-Tíre
Eastern and Midland
Regional Assembly



EMILY SQUARE

Part 8

Plans and particulars for the proposed development of Emily Square in Athy were published on the 17th of July 2018 and were available for inspection until the 14th August 2018.



The following six aims, represent Kildare County Council's overarching design objectives for the Part 8 site:

- Upgrade and enhance the quality of the centre of the town.
- Create a more accessible, de-cluttered and attractive space while also
- Improve pedestrian access and safety, ensuring pedestrians of all ages can enjoy the square.
- Celebrate Heritage, providing a more appropriate setting for buildings and monuments that are intrinsic to the heritage of Athy
- Accentuate Unique Features including the unique features of the newly redeveloped Shackleton Experience Building.
- Increase Flexibility of Use

Overall, the proposed Part 8 public realm interventions to Emily Square were to greatly improve the visual appearance and functionality of the public space and provide a flexible multi-use event space, which in turn would attract more visitors to the square and make it a more attractive environment for users to spend time and money, thereby benefiting businesses on and surrounding the square.

The Part 8 proposals were unanimously approved by the Athy Municipal District on the 19th November 2018.

Project Description

The proposed improvement works comprised:

- footpath widening and resurfacing,
- upgrade of street furniture and street lighting,
- replacement of existing trees with a single specimen tree,
- the removal of 28no. car parking spaces and resurfacing,
- Reconfigured traffic circulation along the R417 comprising the establishment of a one-way system between Leinster Street and Meeting Lane, running in a north to south direction.

- Managed access for servicing and deliveries via restricted access bollards to access road on west side of Square together with establishment of a one-way system, running in a south to north direction and the closure of the local access road in front of the Old Town Hall.
- Sensitive restoration and repositioning of the Maurice Duke of Leinster Drinking Fountain (Protected Structure - RPS No. AY022) and the 1798 Memorial;
- All necessary services and utility provision and associated site works.

Stakeholder/Community Consultation

The Part 8 proposals were progressed and informed by a collaborative engagement process, facilitated by The Paul Hogarth Company on behalf of, and in partnership with, Kildare County Council and Athy Municipal District Council. The process involved stakeholder engagement with local businesses, council officers, elected members of Athy Municipal District and members of the local community. Meetings were also held with design teams taking forward other development proposals in the locality to ensure that the proposed scheme aligned with and supports these development opportunities.

Two public consultation events were held at the Part 8 site. One at the commencement of the project, and the second during the design development stage. Advertised widely in advance, these events provided the opportunity for members of the public to meet the Project Team and share their thoughts and ideas for the future development of the Front Square.

Questionnaires were distributed at the events, with respondents encouraged to document their thoughts about the Front Square. Some of the key findings are summarised below:

How would you describe Emily Square?

Of the 194 responses to this question, the majority (41%) made negative comments about the Front Square with ‘Dangerous/Uneven Paths’ the most common concern raised.



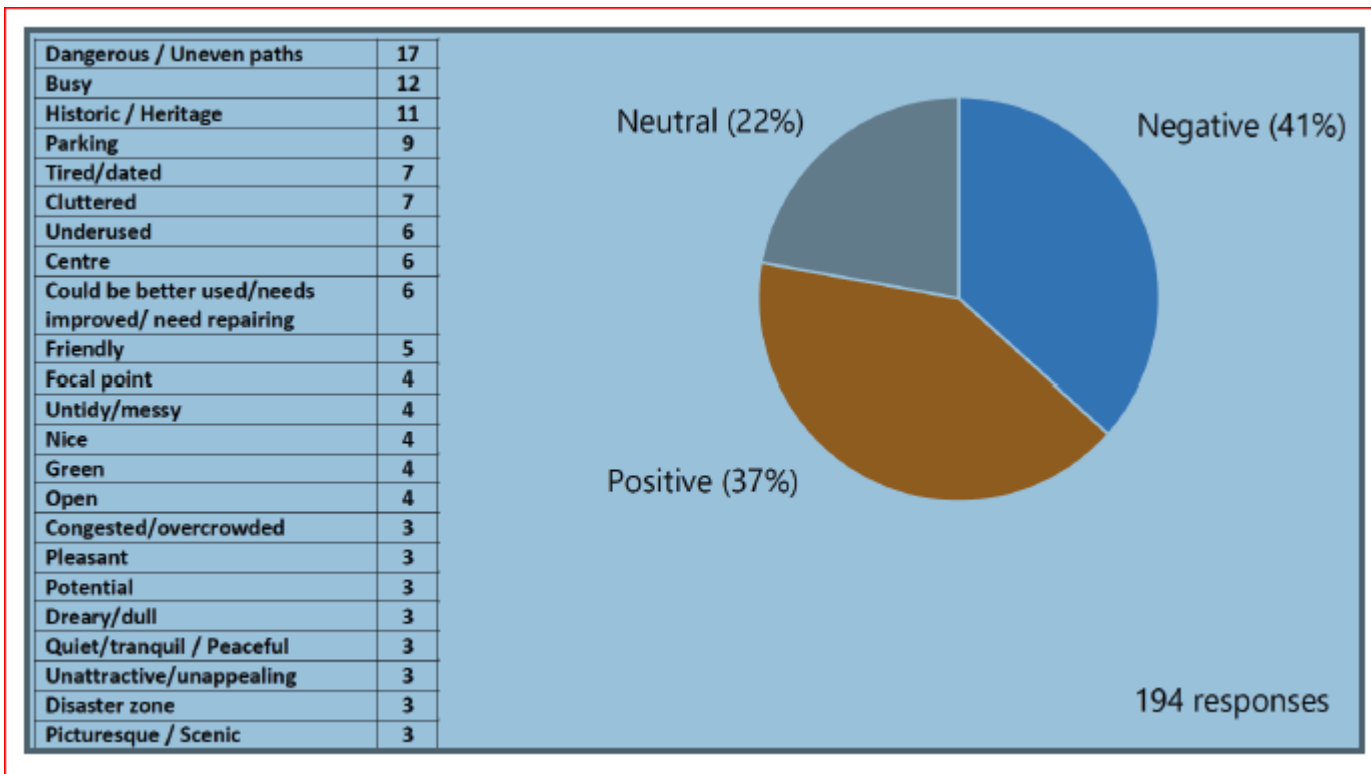

What do you like and dislike about Emily Square?

Heritage/Historic was the main 'like' raised by respondents, while Parking was the main 'dislike' raised. 12 respondents indicated that they liked the trees within the Square, while 18 respondents raised this as a dislike.

Analysis of Findings

Likes

Heritage / Historic	15
Trees	12
Town Hall	9
Central	6
Seating/benches	6
Traditional Market	6
Focal point	4
Buildings	4
Fountain	4
Meeting place	4
Good space	3
Open /open space	3
Shopping/shops	3
Pedestrian friendly	3
Centre of community/ community space	3
Monument	3
River	3

Dislikes

Parking	27
Trees	18
Traffic	17
Footpaths/paving	13
Cluttered	8
Cars	8
Anti-social behaviour	6
Uneven	4
Poor surface	4
Access	4
Unattractive/dilapidated	3
Litter	3
Signs/sign posts	3
Unkept/untidy	3

Conclusion

The Part 8 scheme was considered to be in accordance with the proper planning and development of the area and it has been demonstrated that it aligned with and supported national, regional and local planning policies and objectives. Potential impacts, including environmental, traffic and archaeological were fully assessed, and it was determined that the proposed would have no significant negative impact on the receiving environment.

In achieving the overall design objectives to enhance quality, declutter space, improve pedestrian access and safety, celebrate heritage and accentuate unique features, increase flexibility of use, the proposed scheme would deliver the following benefits for this primary civic space in Athy:

- Improved public realm that conveys a message of quality reflecting the vision held for the town.
- Attractive environment that stimulates increased footfall in Athy town centre.
- Enhanced pedestrian and cycle access to town centre businesses and attractions, assisting in the achievement of a greater degree of sustainable transport in the town.
- Safer environment for all users, particularly for those with disabilities and using buggies.
- Improved environment after dark, addressing issues relating to anti-social behaviour
- Enhanced setting of heritage assets, including the Old Town Hall (Shackleton Building) and the Duke of Leinster Drinking Fountain.
- Enhancement of the heritage significance of Emily Square and Athy thereby providing an educational resource and tourist attraction.
- Improved views and vistas within and through the Part 8 site
- Increased opportunities for outdoor events and activities for the local community, including outdoor seating, dining, markets and festivals.
- Improved arrangement for servicing and deliveries
- Improved planting arrangement and creation of a landmark 'Town Tree'.

The Part 8 proposals were unanimously approved by the Athy Municipal District on the 19th of November 2018.

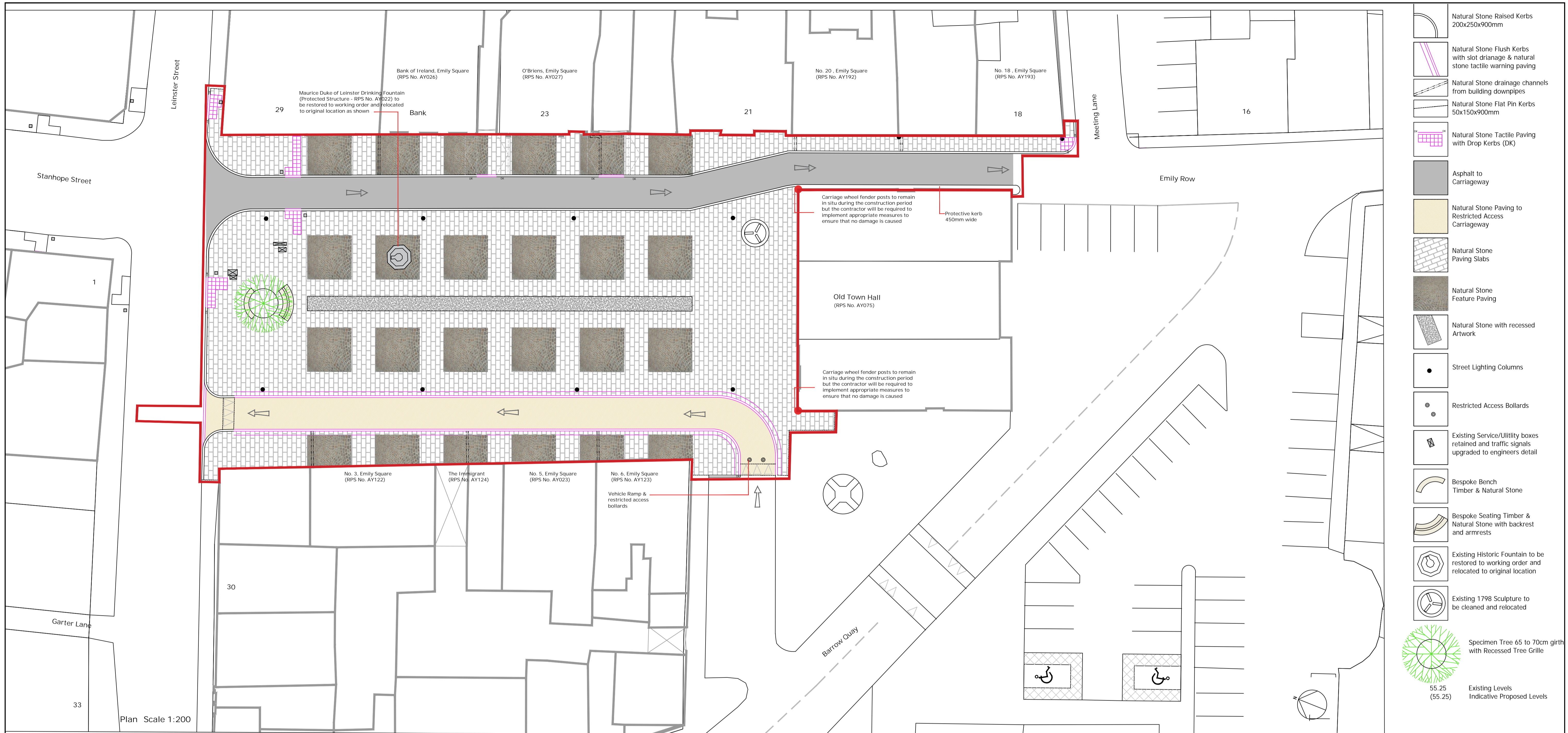

Note:
For all Traffic Signage and White Lining refer to Engineers Information

Revision	Description	Date	Initial
A01	Issued for Information	02.07.18	SM
A02	Issued for Planning	17.07.18	SM

Materials - Example Images:



Example of Inlaid Artwork recessed within paving
 Example of Natural Stone paving to footpaths
 Example of Natural Stone Feature Paving
 Example of Natural Stone Paving to Restricted Access Road only, with flush stone kerbs and contrasting stone tactile paving



Example of Large Tree installed within Natural Stone Paving
 Example of 9m Lighting Column with upper and lower fittings
 Example of LED Luminaires
 Example of Bespoke Seating

the paulhogarth company
 landscape architecture urban design
 potters quay, 5 rovenhill road, bellfast BT6 8DN
 telephone: 028 9073 6690 fax: 028 9073 2705
 email: belfast@paulhogarth.com www.paulhogarth.com

client
Kildare County Council

project title
Environmental Improvement Works To Front of Emily Square

drawing title
Landscape Layout

drawn by SM	checked by J H	scale @ A1 1:200	revision A02
project no. 16030B	date 10/11/2017	drawing no. LA-101	

status: **Planning**

All legal drawings to be read in conjunction with details and specifications. Any discrepancies to be brought to the attention of the Landscape Architect.

Widened Footpath One Way Carriageway with Raised Kerbs Natural Stone Paving, Street Lighting & Specimen Tree with Formalised Market Layout One Way Restricted Access Road, Flush Kerbs & Tactile Paving Widened Footpath



Existing Footpath Existing Two Way Carriageway width Existing Two Way Carriageway width Existing Footpath

Section/Elevation A-A Showing widened footpaths, one way carriageways and street lighting Scale 1:100

Footpath re-surfaced Leinster Road & Junction Re-surfaced Specimen Tree with New Seating New Natural Stone & Artwork within Paving Existing Asphalt Road removed & replaced with new Natural Stone Paving



Existing Two Way Carriageway Width Retained Existing Carriageway Closed

Section B-B Showing New tree, Seating and Paving Scale 1:100

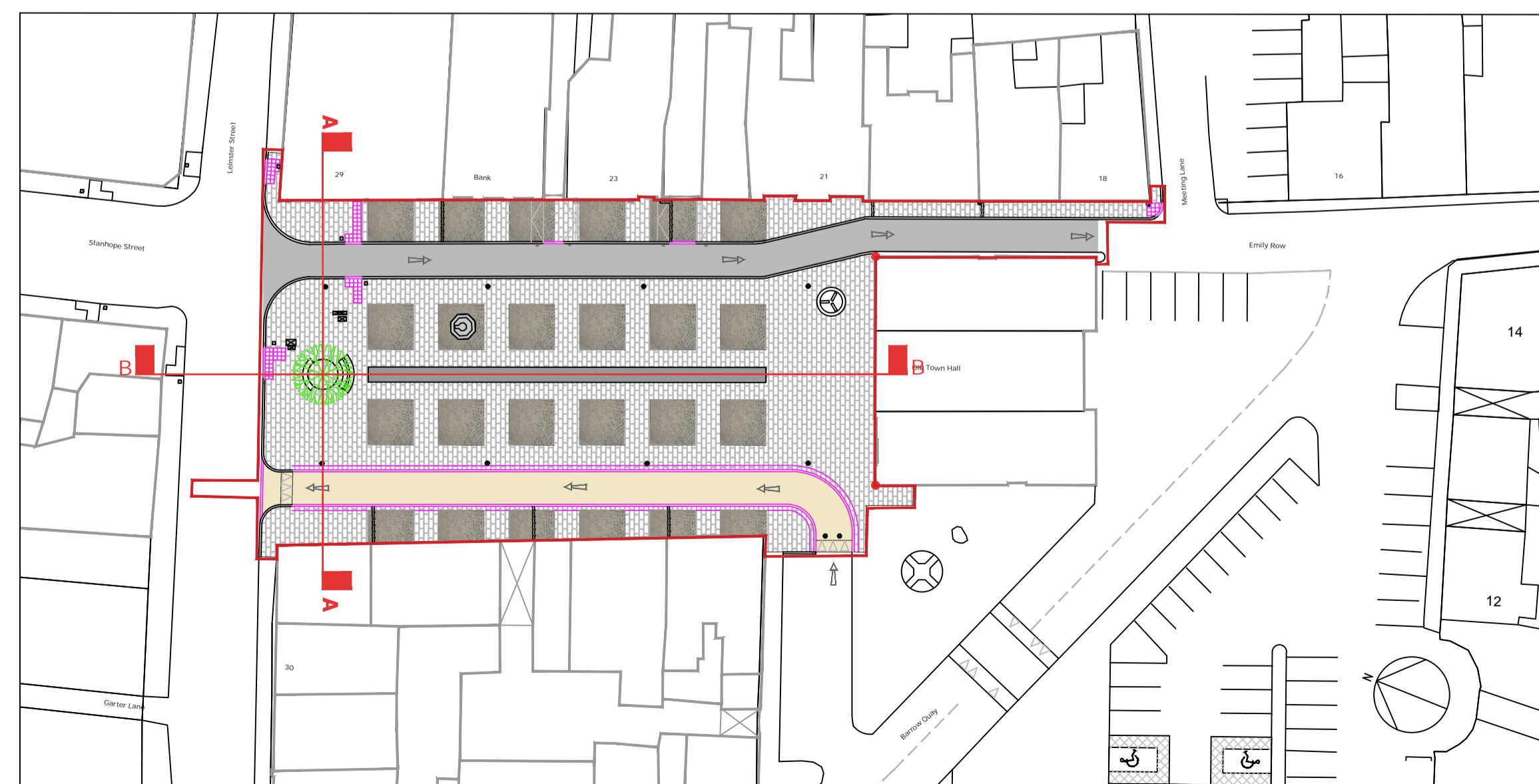

Plan Scale 1:500

55.25 Existing Levels
(55.25) Indicative Proposed Levels

Note:
For all Traffic Signage and White Lining refer to Engineers Information

Revision	Description	Date	Initial
A01	Issued for Planning	17.07.18	SM

the paulhogarth company
 landscape architecture urban design
 potters quay, 5 ravenhill road, belfast BT6 6DN
 telephone: 028 9073 6690 fax: 028 9073 2705
 email: belfast@paulhogarth.com www.paulhogarth.com

client
 Kildare County Council

project title
 Environmental Improvement Works
 To Front of Emily Square







drawing title
 Landscape Sections

drawn by SM	checked by J H	scale @ A1 1:100	revision A01
project no. 16030B	date 10/11/2017	drawing no. LA-102	

status.
Planning

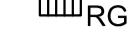
All legal drawings to be read in conjunction with details and specifications. Any discrepancies to be sought for the attention of the Landscape Architect.

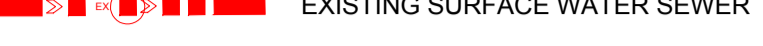
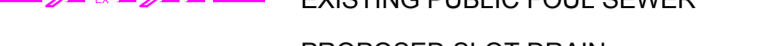
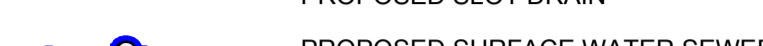
LEGEND:

-  SLOT DRAIN OUTLET
-  EX. G
-  PROPOSED ROAD GULLY
-  EXISTING PUBLIC COMBINED SEWER
-  EXISTING SURFACE WATER SEWER
-  EXISTING PUBLIC FOUL SEWER
-  PROPOSED SLOT DRAIN
-  PROPOSED SURFACE WATER SEWER

NOTE:

- SLOT DRAINS SHOWN INDICATIVELY. TO BE COORDINATED WITH LANDSCAPE ARCHITECT DESIGN.
- SLOT DRAINS TO CONNECT TO PROPOSED SURFACE WATER NETWORK VIA SUMP OUTLET.
- PROPOSED OUTLET SPACINGS PROVISIONAL ONLY.
- EXISTING SURFACE WATER SEWER BASED ON PUBLIC RECORDS. LOCATION AND LEVELS TO BE CONFIRMED.
- REFER TO LANDSCAPE ARCHITECTS DESIGN FOR PAVING DETAILS & PROPOSED FINISHED LEVELS.

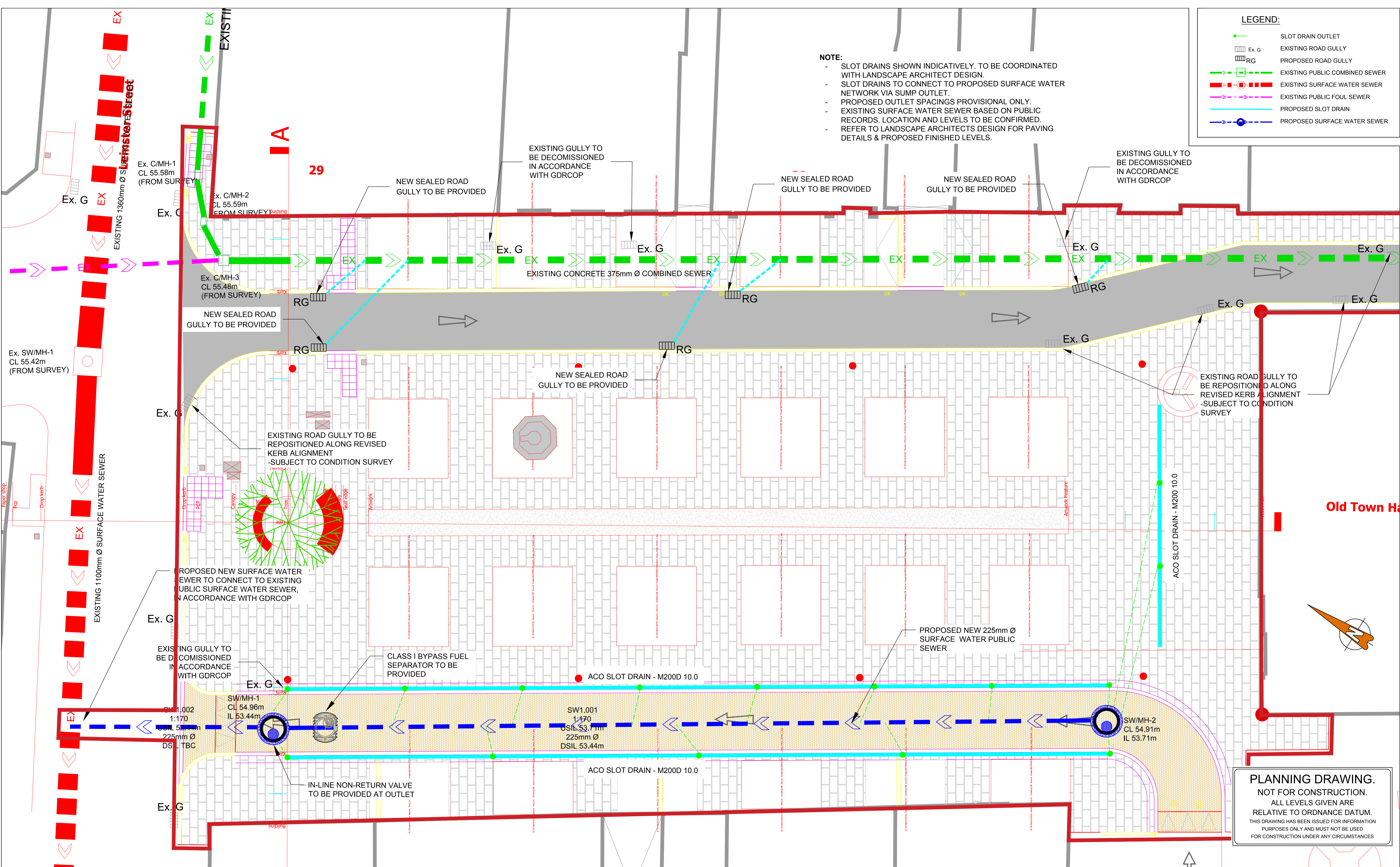

PLANNING DRAWING.
 NOT FOR CONSTRUCTION.
 ALL LEVELS GIVEN ARE
 RELATIVE TO ORDNANCE DATUM.
 THIS DRAWING HAS BEEN ISSUED FOR INFORMATION
 PURPOSES ONLY AND MUST NOT BE USED
 FOR CONSTRUCTION UNDER ANY CIRCUMSTANCES

NOTES

- For setting out refer to Engineer's drawings.
- This drawing to be read in conjunction with all other Engineering drawings and all other relevant drawings and Specifications.
- DO NOT SCALE THIS DRAWING. Use figured dimensions only.
- No part of this document may be reproduced or transmitted in any form or stored in any retrieval system of any nature without the written permission of O'Connor Sutton Cronin as copyright holder except as agreed for use on the project for which the document was originally issued.
- Ordnance Survey of Ireland licence no. EN0000817 © Government of Ireland

Rev. No.	Date	REVISION NOTE	Drn. By	Chkd. By	Rev. No.	Date	REVISION NOTE	Drn. By	Chkd. By
P1	06.02.2018	ISSUED FOR INFORMATION	HD	MK					
P2	04.07.18	ISSUED FOR PLANNING	HD	MK					
P3	13.07.2018	ISSUED FOR PLANNING	SMC	MK					

OCSC
 Multidisciplinary Consulting Engineers
 O'Connor Sutton Cronin & Associates Ltd.
 9 Prussia St.,
 Dublin 7.

Client: KILDARE COUNTY COUNCIL
 Project: EMILY SQUARE, ATHY, CO. KILDARE
 Title: PROPOSED DRAINAGE LAYOUT

Drn. by: KD
 Chkd. by: MK
 Date: 15.01.2018
 Scale: 1:100
 Revision: P3

Office Locations | Dublin (Head Office) | London | Cork | Galway | Belfast | Warsaw | Bucharest | Moscow | Abu Dhabi | Libya |